

YA RATELTAKEL 3200/6300/9000 KG

**DETAIL DRAWING : YA-80.100.160.320.630.900.**

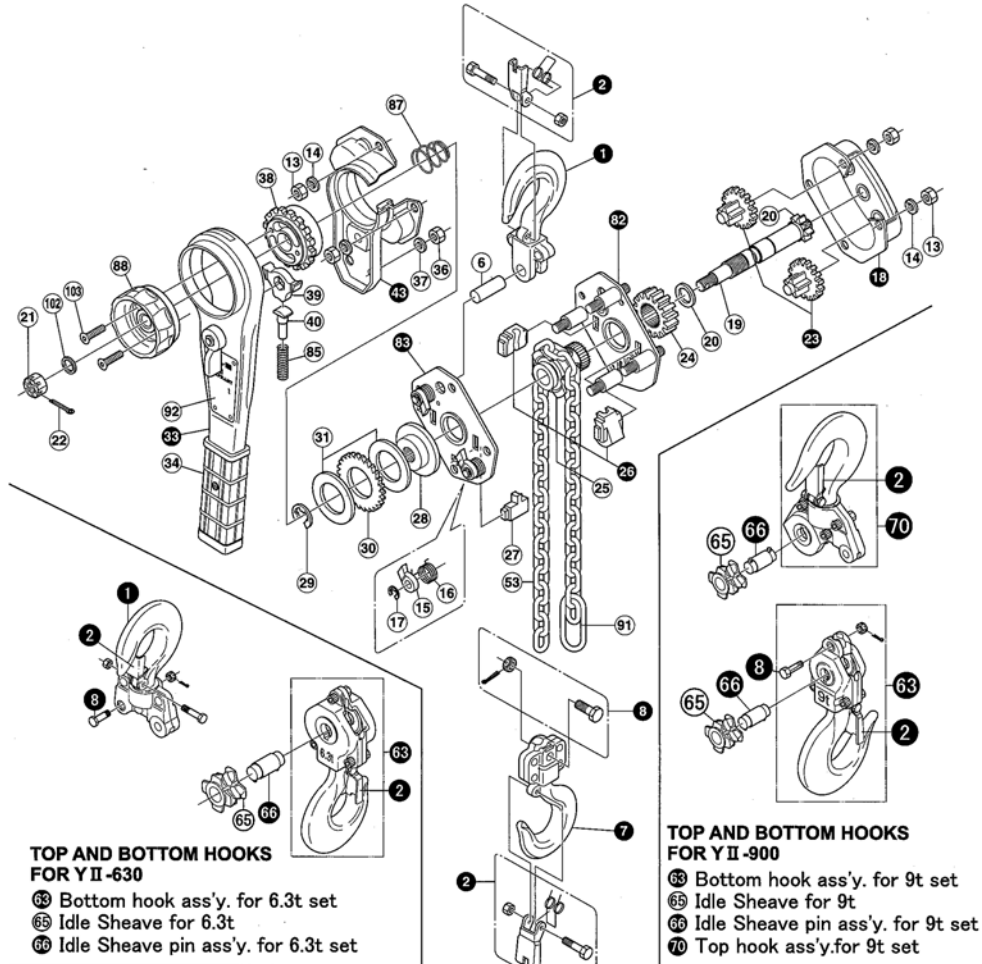

**TOP AND BOTTOM HOOKS FOR Y II-630**  
 63 Bottom hook ass'y. for 6.3t set  
 65 Idle Sheave for 6.3t  
 66 Idle Sheave pin ass'y. for 6.3t set

**TOP AND BOTTOM HOOKS FOR Y II-900**  
 63 Bottom hook ass'y. for 9t set  
 65 Idle Sheave for 9t  
 66 Idle Sheave pin ass'y. for 9t set  
 70 Top hook ass'y. for 9t set

**Y II-80.100.160.320.630.900**

- |                            |                               |                                  |
|----------------------------|-------------------------------|----------------------------------|
| 1 Top hook ass'y set       | 22 Cotter pin                 | 38 Feed gear                     |
| 2 Safety latch set         | 23 2nd and 3rd gear ass'y set | 39 Ratchet for feed gear         |
| 3 Top hook pin             | 24 Load gear                  | 40 Ratchet spring pin            |
| 7 Bottom hook ass'y set    | 25 Load sheave                | 43 Lever cover set               |
| 8 Chain stop bolt set      | 26 Chain guide ass'y set      | 53 Load chain set                |
| 13 Hex. nut                | 27 Chain stripper             | 62 Gear-side plate ass'y set     |
| 14 Spring washer           | 28 Disc hub                   | 63 Lever-side plate ass'y set    |
| 15 Pawl                    | 29 E-ring for disc hub        | 65 Ratchet spring                |
| 16 Pawl spring             | 30 Ratchet wheel              | 67 Spring for floating mechanism |
| 17 E-ring for pawl         | 31 Brake lining               | 68 Feed handle                   |
| 18 Gear cover ass'y set    | 34 Lever grip set             | 91 Chain stopper                 |
| 19 Pinion shaft            | 35 Hex. nut                   | 92 Name plate                    |
| 20 Washer for pinion shaft | 37 Spring washer              | 102 Check Washer                 |
| 21 Hex. castle nut         |                               | 103 Countersunk bolt             |

TEK.NUMMER	OMSCHRIJVING	ARTIKELNUMMER
1	YA-3,2T-01 BOVENHAAKSET	4355100
1	YAS-32-01 BOVENSCHEEPSWERFHAAK	4355101
2	YA-3,2 T-02 VEILIGHEIDSKLEP	4355102
7	YA-3,2T-07 ONDERHAAKSET	4355105
6	YA-3,2/6,3/9T-06 BOVENHAAKPEN	1355106
7	YAS-32-07 ONDERSCHEEPSWERFHAAK	4355107
8	YA-3,2T-08 BOUT ONDERHAAK	4355108
13/14	YA-3,2/6,3/9T-13/14 MOER+VEERRING	4355113
15/16/17	YA-3,2/6,3/9T-15/16/17 PALSET	4355115
18	YA-3,2/6,3/9T-18 TANDWIELKAST	4355118
19/20	YA-3,2/6,3/9T-19/20 AANDRIJF AS+RING	4355119
21	YA-3,2/6,3/9T-21 KROONMOER	4355121
23	YA-3,2/6,3/9T-23 TANDWIEL PAAR	4355123
24	YA-3,2/6,3/9T-24 TANDWIEL	4455124
25	YA-3,2/6,3/9T-25 NESTENSCHIJF	4455125
26	YA-3,2/6,3/9T-26 KETTINGGELEIDER	4455126
27	YA-3,2/6,3/9T-27 KETTINGSTRIPPER	4455127
28	YA-3,2/6,3/9T-28 NAAFWIEL	4455128
29	YA-3,2/6,3/9T-29 E RING TBV AANDRIJFAS	4455129
30	YA-3,2/6,3/9T-30 PALWIEL	4455130
31	YA-3,2/6,3/9T- 31 REMSCHIJFSET	4455131
33	YA-3,2/6,3/9T-33 (33+34+92) HANDEL	4455133
34	YA-3,2/6,3/9T-34 RUBBER HANDVAT	4455134
	YA-3,2/6,3/9T-MOER+VEERRING HANDEL	4455136
38	YA-3,2/6,3/9T-38 PALWIEL	4455138
39	YA-3,2/6,3/9T-39 OSSENKOP	4455139
40	YA-3,2/6,3/9T-40 PEN TBV OSSENKOP	4455140
43	YA-3,2/6,3/9T-43 REMHUIS	4455143
82	YA-3,2/6,3/9T-82 ZIJPLAATSET TANDW.	4455182
83	YA-3,2/6,3/9T-83 ZIJPLAATSET WIEL ZIJDE	4455183
85	YA-3,2/6,3/9T-85 VEER	4455185
87	YA-3,2/6,3/9T-87 VRIJLOOP VEER	4455187
88	YA-3,2/6,3/9T-88 HANDWIEL	4455188
91	YA-3,2/6,3/9T-91 EINDRING	4455191
92	YA-3,2T-92 NAAMPLAAT	4455192
92	YAS-3,2-92 NAAMPLAAT YAS	4355092
103	YA-3,2/6,3/9T-103 SCHROEF	4455193
1	YA-6,3T-01 BOVENHAAKSET	4356101
7	YA-6,3T-07 ONDERHAAKSET	4356103
92	YA-6,3T-92 NAAMPLAAT	4356105

2	YA-6,3T-02 VEILIGHEIDSKLEP	4356107
65	YA-6,3T/9T-65 NESTENSCHIJF ONDERHAAK	4356109
66	YA-6,3T/9T-66 AS TBV NESTENSCHIJF HAAK	4356111
1	YA-9T-01 BOVENHAAKSET	4356120
7	YA-9T-07 ONDERHAAKSET	4356123
92	YA-9T-92 NAAMPLAAT	4356125
2	YA-9T-02 VEILIGHEIDSKLEP	4356127
65	YA-6,3T/9T-65 NESTENSCHIJF ONDERHAAK	4356129
66	YA-6,3T/9T-66 AS TBV NESTENSCHIJF HAAK	4356131