

SS.SE.B

STAINLESS STEEL SWIVEL EYE BOLT

METRIC THREADS

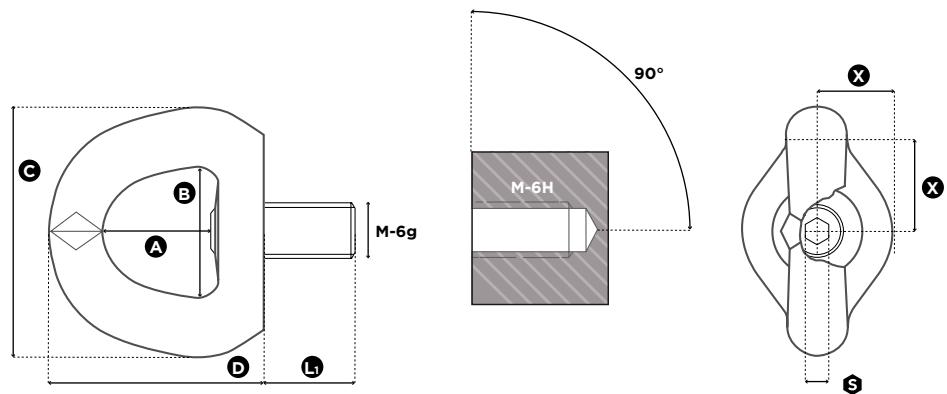

1 in = 25.4 mm

Reference	Diameter	SF 5:1 WLL (t)	SF 4:1 WLL (t)	Standard L ₁ (mm)	Torque (Nm)		S (mm)	A (mm)	B (mm)	C (mm)	D (mm)	Weight	
												(kg)	(lbs)
SS.SE.B M 8	M 8 (x1,25)	0,20	0,20	14	6	20	6	30	34	60	57	0,24	0,53
SS.SE.B M 10	M 10 (x1,5)	0,30	0,30	17	10	20	6	30	34	60	57	0,24	0,53
SS.SE.B M 12 0,4t	M 12 (x1,75)	0,40	0,40	21	15	20	6	30	34	60	57	0,24	0,53
SS.SE.B M 12	M 12 (x1,75)	0,55	0,55	21	15	35	8	38	45	90	80	0,80	1,76
SS.SE.B M 16	M 16 (x2)	1,20	1,20	27	50	35	8	38	45	90	80	0,82	1,81
SS.SE.B M 20	M 20 (x2,5)	1,50	1,50	30	100	35	8	38	45	90	80	0,84	1,85
SS.SE.B M 24	M 24 (x3)	2,50	2,50	36	100	50	8	38	45	90	80	0,90	1,98

02.2024



SS.SEB

STAINLESS STEEL SWIVEL EYE BOLT

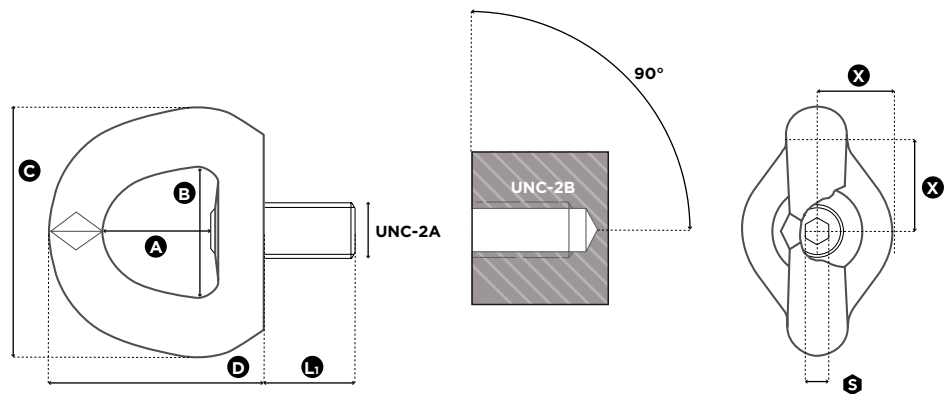
UNC THREADS



1 in = 25.4 mm

Reference	Diameter	SF 5:1 WLL (lbs)	SF 4:1 WLL (lbs)	Standard L ₁ (mm)	Torque (ft-lb)			A (mm)	B (mm)	C (mm)	D (mm)	Weight	
												(kg)	(lbs)
SS.SEB U 038	UNC 3/8"-16	550	550	17	8	20	6	30	34	60	57	0,24	0.53
SS.SEB U 050	UNC 1/2"-13	880	880	21	12	20	6	30	34	60	57	0,24	0.53

02.2024



SS.SEB

STAINLESS STEEL SWIVEL EYE BOLT

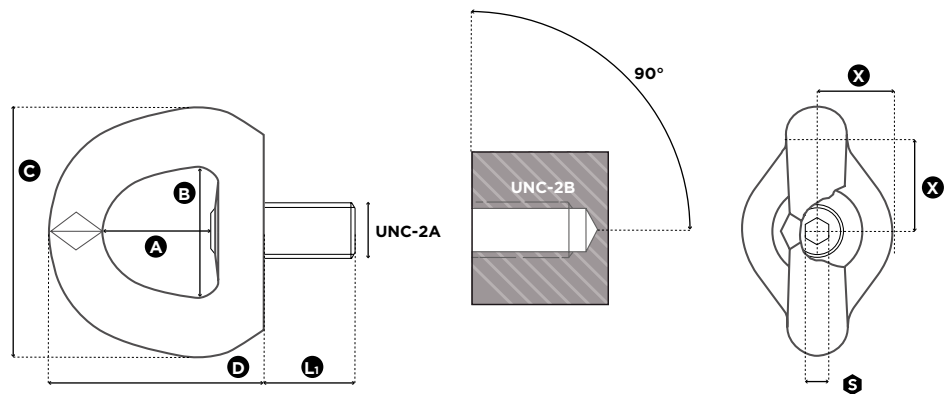
UNC THREADS (INCH)



1 in = 25.4 mm

Reference	Diameter	SF 5:1 WLL (lbs)	SF 4:1 WLL (lbs)	Standard L _i (inch)	Torque (ft-lb)			A (inch)	B (inch)	C (inch)	D (inch)	Weight	
												(kg)	(lbs)
SS.SEB U 038	UNC 3/8"-16	550	550	0.67	8	0.79	0.24	1.18	1.34	2.36	2.24	0.24	0.53
SS.SEB U 050	UNC 1/2"-13	880	880	0.83	12	0.79	0.24	1.18	1.34	2.36	2.24	0.24	0.53

02.2024